

Pentomino puzzles I: try to fit your pieces into these shapes

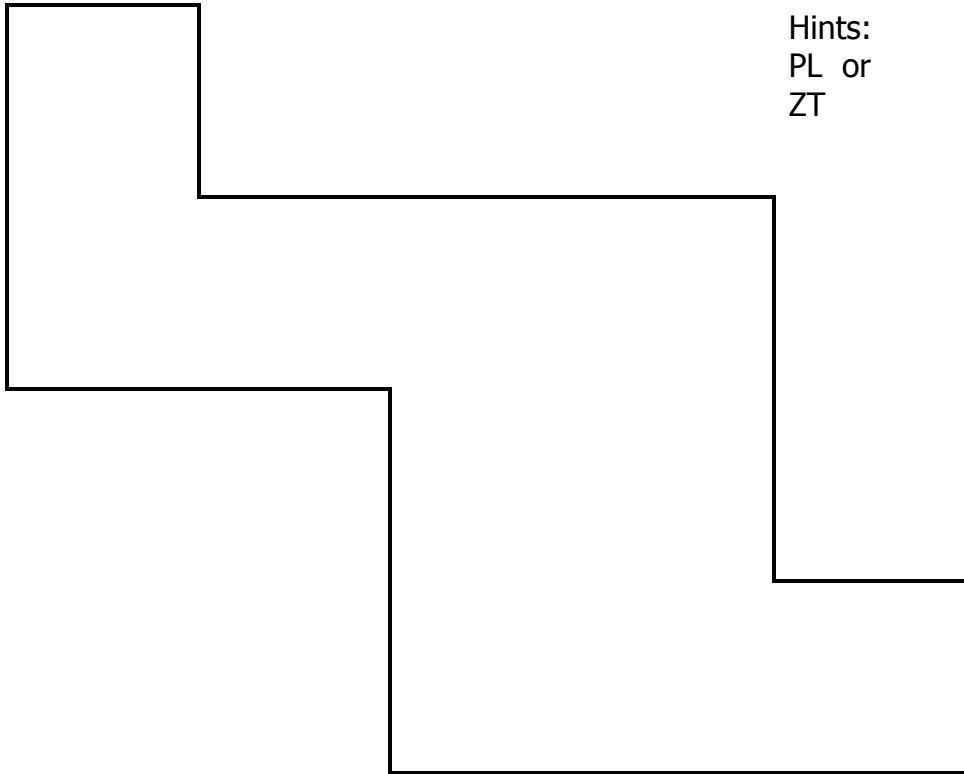

Hints:  
PL or  
ZT

Hint:  
UWF

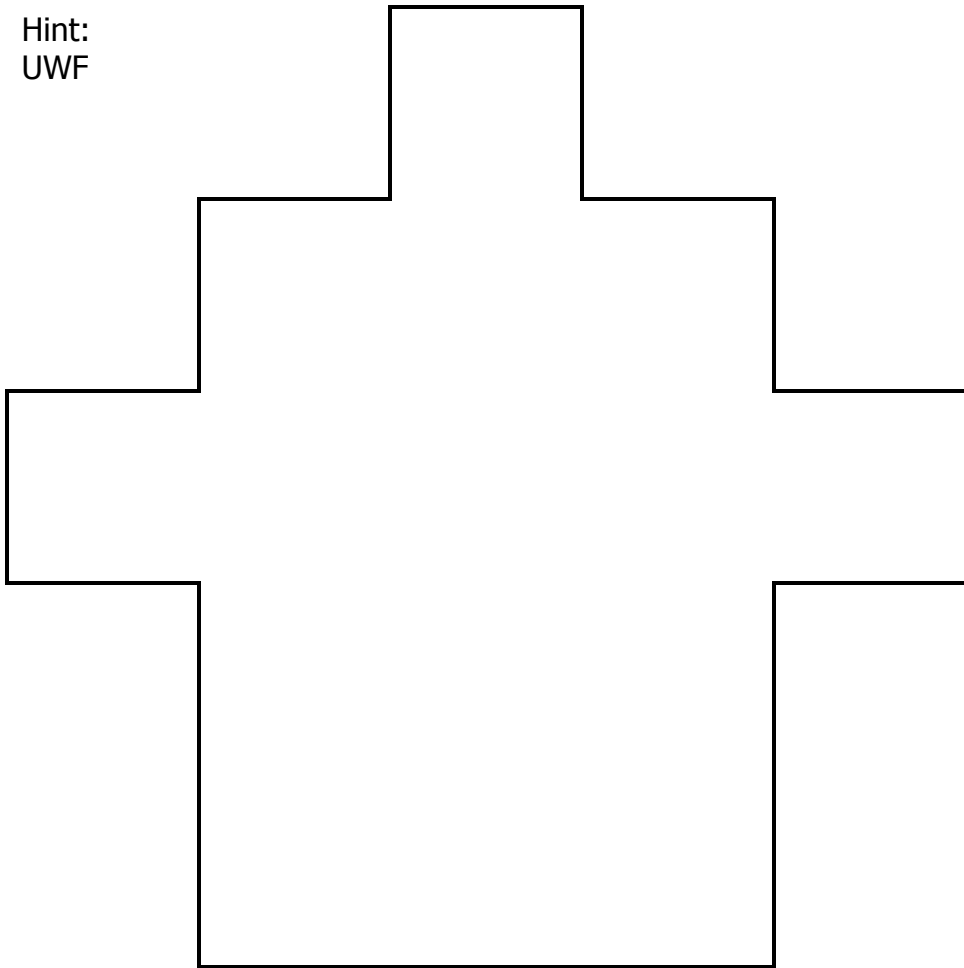

Pentomino puzzles II: try to fit your pieces into this shape

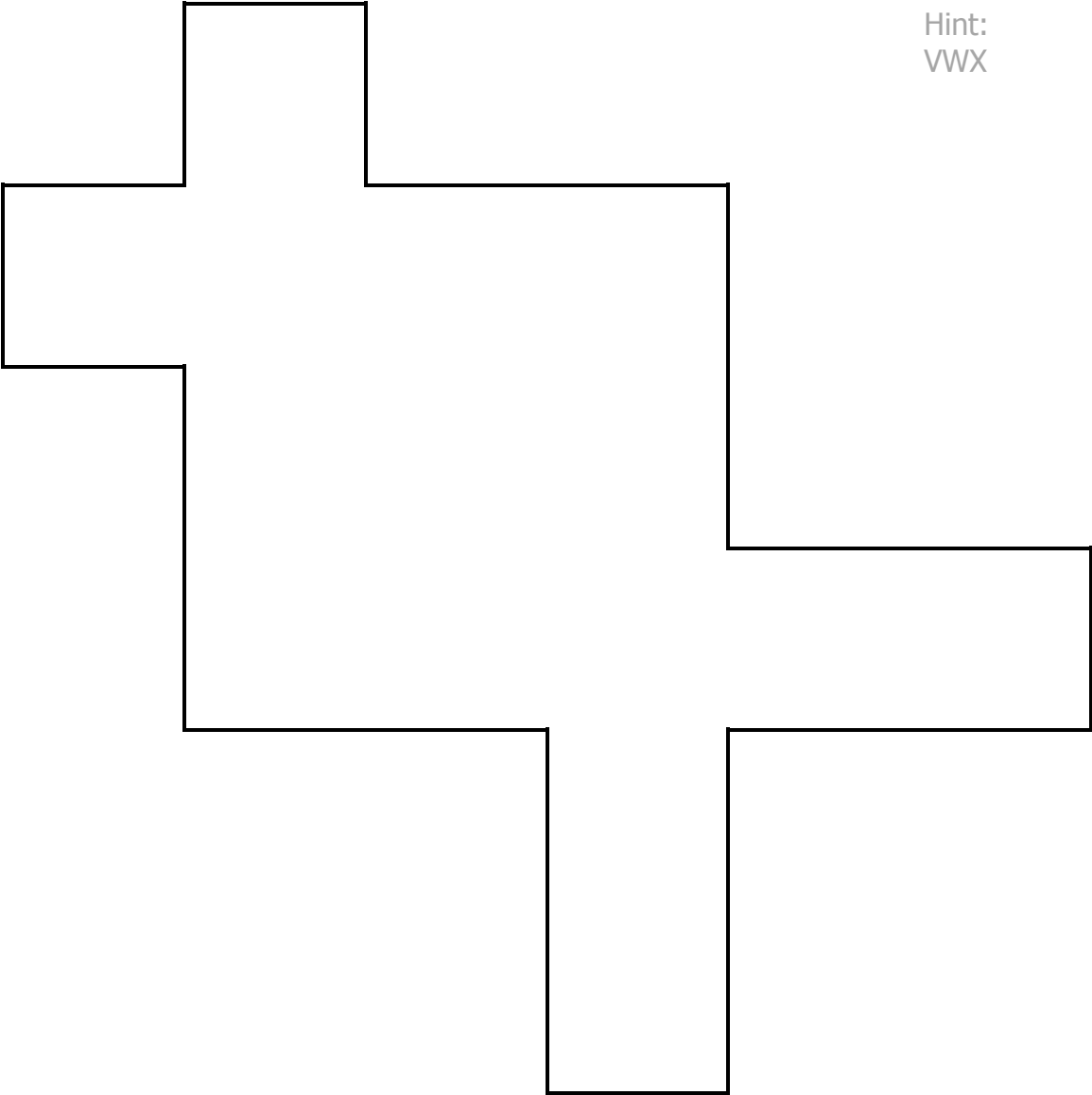

Hint:  
VWX

Pentomino puzzles III: try to fit your pieces into these shapes

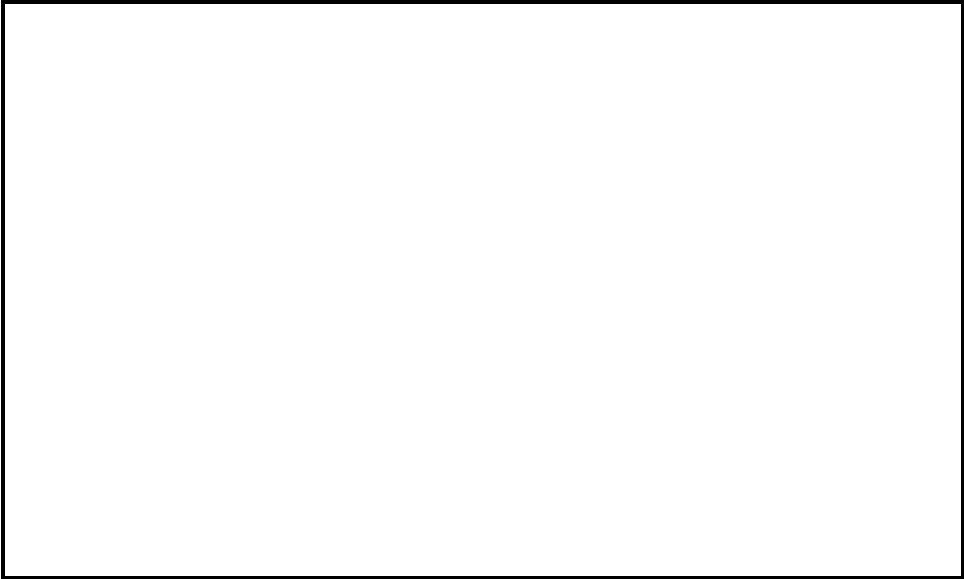

Hints:  
PUN  
TYL

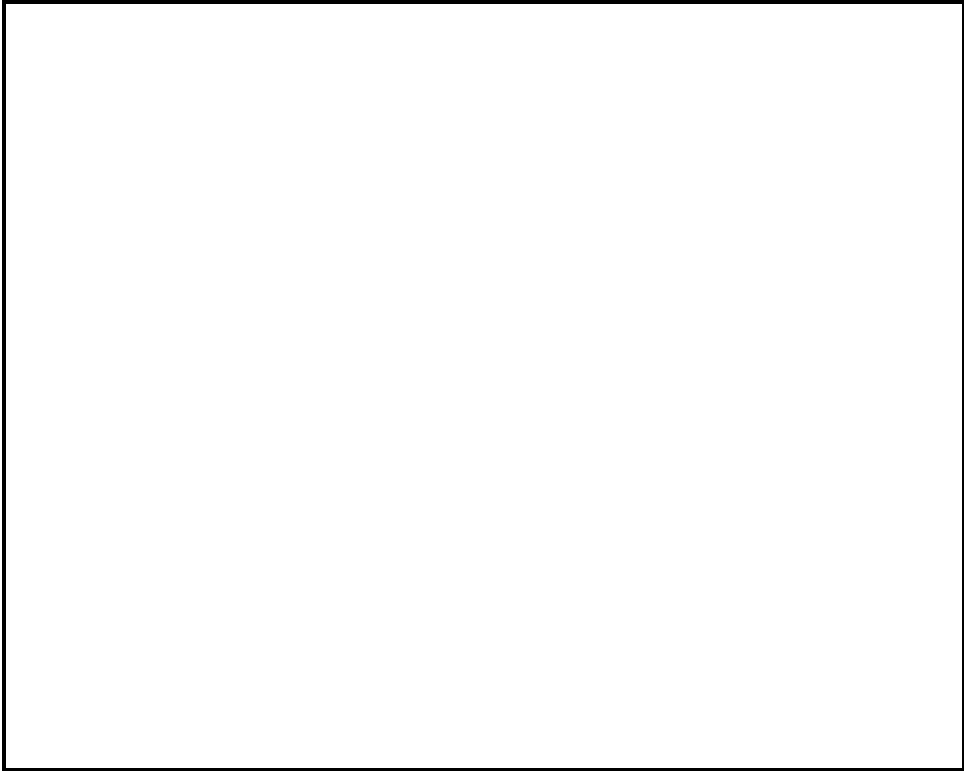

Hints:  
PLWY  
VZLP

Pentomino puzzles IV: try to fit your pieces into these shapes

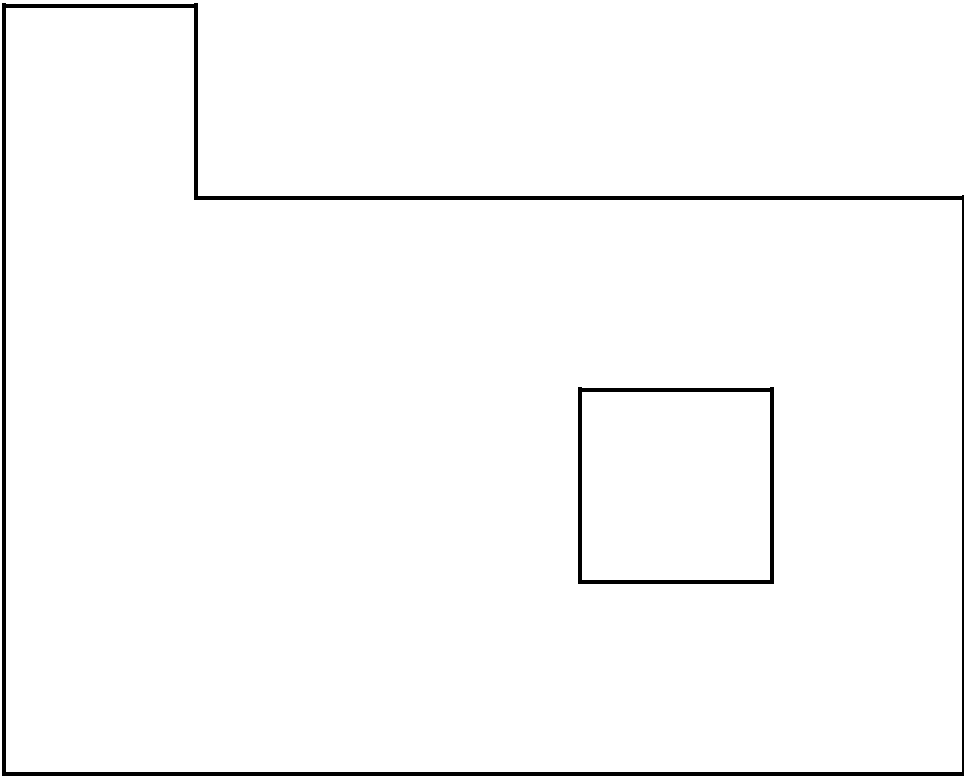

Hint:  
VIL

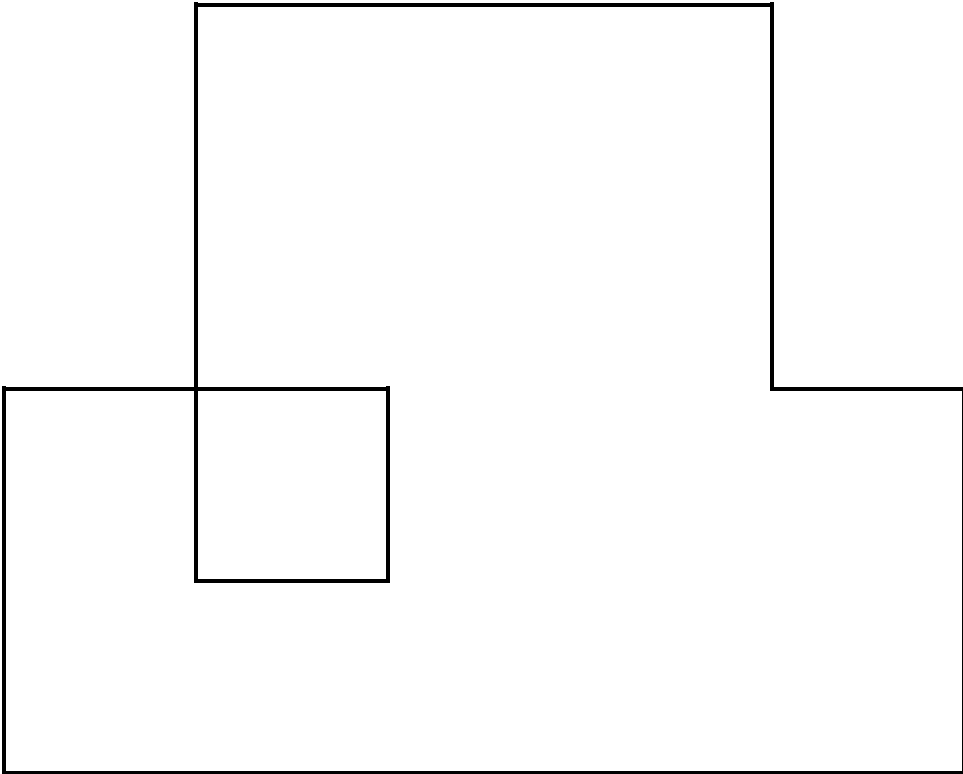

Hint:  
LUZ

Pentomino puzzle V: try to fit your pieces into this shape

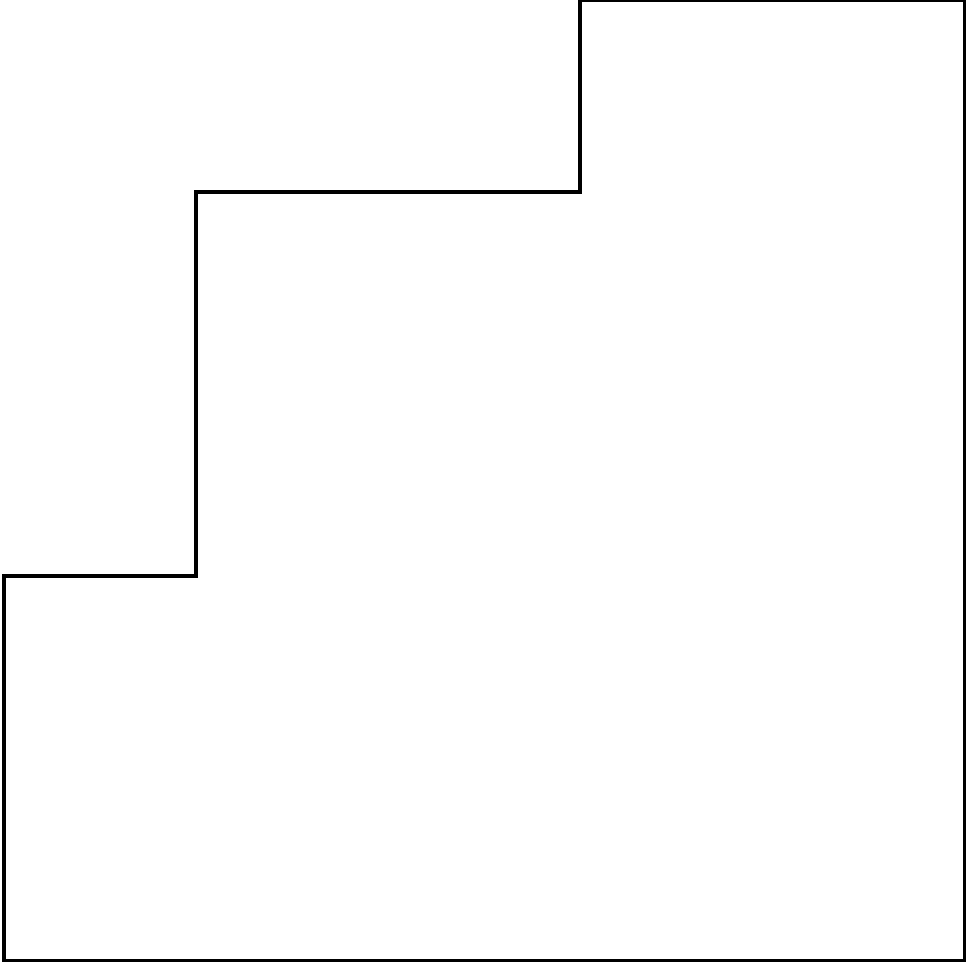

Hint:  
LINZ

Pentomino puzzle VI: try to fit your pieces into this shape

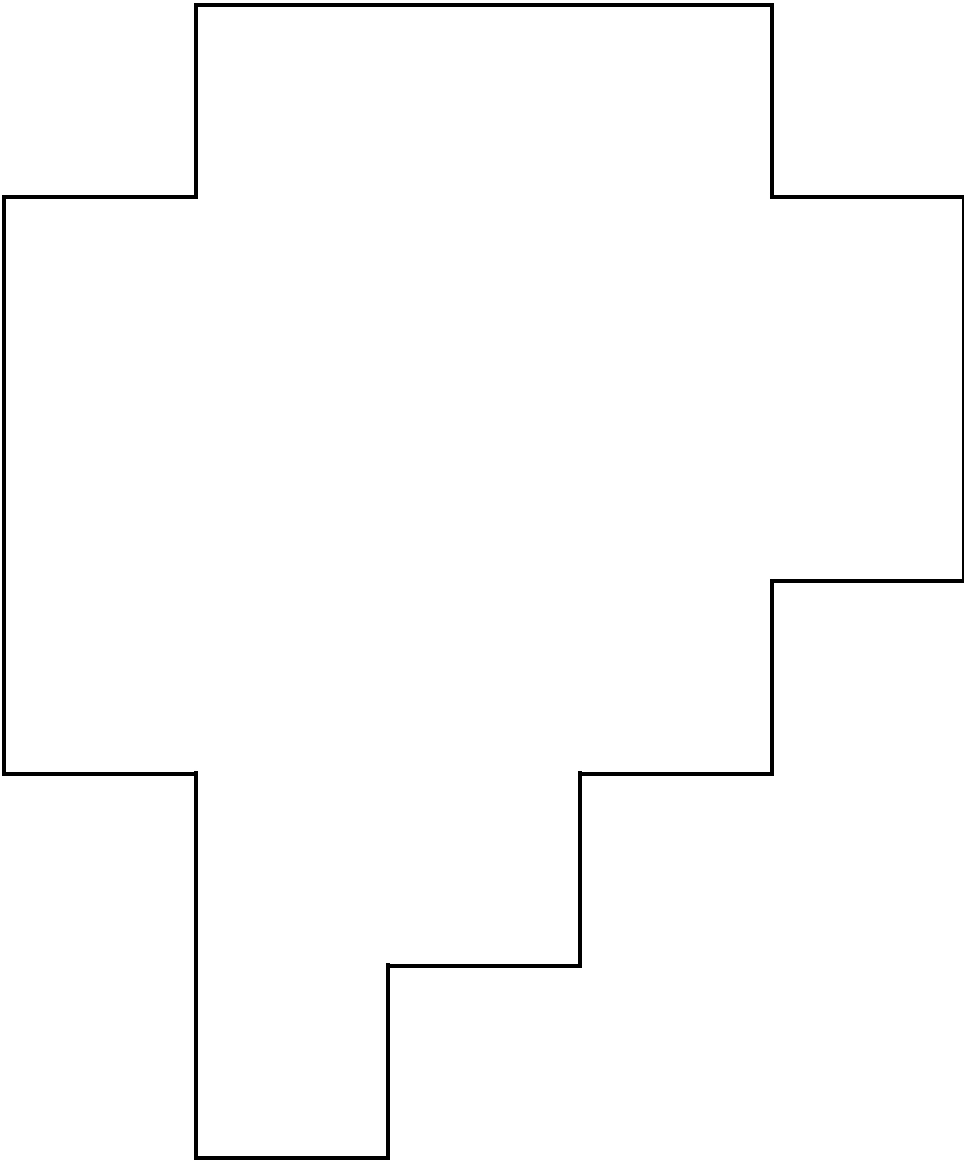

Hint:  
FWNP

Pentomino puzzle VII

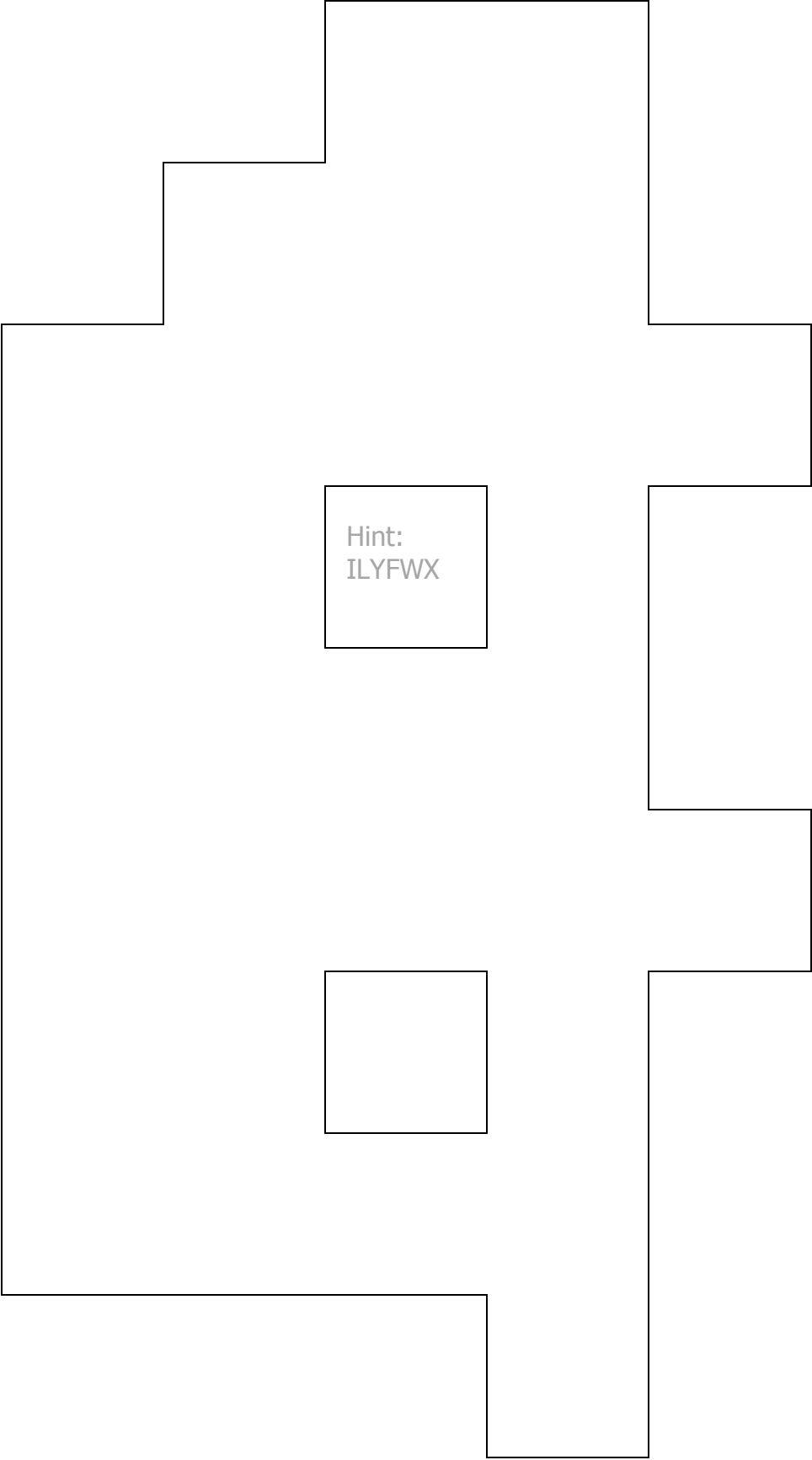

Pentomino puzzle VIII

